

REINFORCE EXPOSE THE INNER FORMS OF TOMORROW

BY GRAMAZIO KOHLER RESEARCH
Milan, 5 April - 6 May 2017
Via Vecchio Politecnico, 3

(1)
Mesh Mould
Fabrication Study, 2016
Robotically welded metal mesh,
wooden base

(2)
Mesh Mould
Fabrication Study, 2016
Robotically welded metal mesh
partially filled with concrete

(3)
Mesh Mould
Fabrication Study, 2016
Robotically welded metal mesh

(4)
Mesh Mould
Concept Model, 2015
Manually welded metal mesh

(5)
Mesh Mould
Fabrication Study, 2016
Robotically welded metal mesh

(6)
Mesh Mould
Concept Model, 2015
Manually welded metal mesh

(7)
Mesh Mould
Concept Model, 2015
Manually welded metal mesh

(8)
Mesh Mould
Fabrication Study, 2016
Robotically welded metal mesh
filled with concrete and manually
troweled, concrete base

(9)
Mesh Mould
Fabrication Study, 2016
Robotically welded metal mesh
filled with concrete and manually
troweled, concrete base

(10)
Mesh Mould
Pre-Study, 2015
Robotically bent and manually
welded metal mesh

(11)
Mesh Mould
Structural Test Specimen, 2016
Metal mesh cast in concrete

(12)
Mesh Mould
Fabrication Study, 2017
Robotically welded metal mesh

(13)
Design and Assembly of
Lightweight Metal Structures
Fabrication Demonstrator, 2016
Robotically assembled metal
tubes, steel base

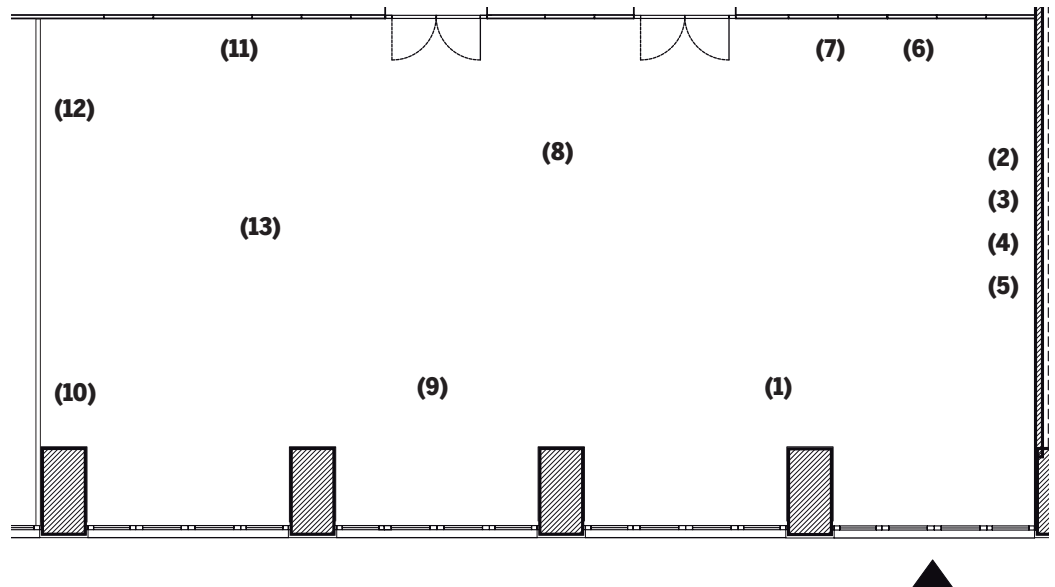

MESH MOULD

Collaborators: Norman Hack (project lead), Dr. Nitish Kumar, Kathrin Dörfler, Alexander Nikolas Walzer, Dr. Jaime Mata Falcon, Michael Lyrenmann, Lex Reiter, Dr. Tim Wangler, Philippe Fleischmann, Andreas Reusser.
Selected experts: Agile & Dexterous Robotics Lab, Institute of Robotics

and Intelligent Systems, ETH Zurich; Physical Chemistry of Building Materials group, Institute for Building Materials, ETH Zurich; Concrete Structures and Bridge Design, Institute for Structural Engineering, ETH Zurich. *Industry partner:* Sika Technology AG, Switzerland.

DESIGN AND ASSEMBLY OF LIGHTWEIGHT METAL STRUCTURES

Collaborators: Stefana Parascho (project lead), Augusto Gandia, Dr. Thomas Kohlhammer, Dr. Ammar Mirjan, Lukas Stadelmann, Michael Lyrenmann, Philippe Fleischmann.
Selected experts: Agile & Dexterous Robotics Lab, Institute of Robotics and Intelligent Systems, ETH Zurich.

Curators:
Samuel Gross, Hannes Mayer
Exhibition coordination:
Claudia Buraschi